

Models: TFA	Category: Fluid Control Unit
	Application: Oil, Water & Chemical Series
	Classification: Constant Capacity Type Solenoid Pump with Twice Fluid Atomizer

FEATURES:

- This unit is a liquid atomizing device of the gas assistance developed by applying a constant capacity type solenoid pump.
- As an assistance fluid, air or other compressibility gases, which can be, conserved a large amount of energy are used.
- The changeable range widely reaches 100:1 or less because the flow rate of the liquid is decided by both a constant capacity type solenoid pump that controls a liquid amount and the assistance gas pressure.

PRIMARY APPLICATION

- NOx reduction device in exhaust emission of internal combustion engine
- Mixture type liquid combustion device
- Humidifying device · Other

SPECIFICATION (This numerical value is driving by the 50Hz (frequency) and the duty ratio 25%.)

SPECIFICATION		MODELS	(S Type)	(M Type)
Fluid	Liquid		Water and other liquid	
	Gas		Compressed Air	
Inlet Pressure	Liquid		100kPa	
	Gas			
Liquid Flow Rate			0 ~ 20 ml/min	0 ~ 100 ml/min
Flow Control			PFM Control under Constant Air Pressure	
Power Sources			24VDC or 12VDC	
Power Consumption (Typical)			30VA	

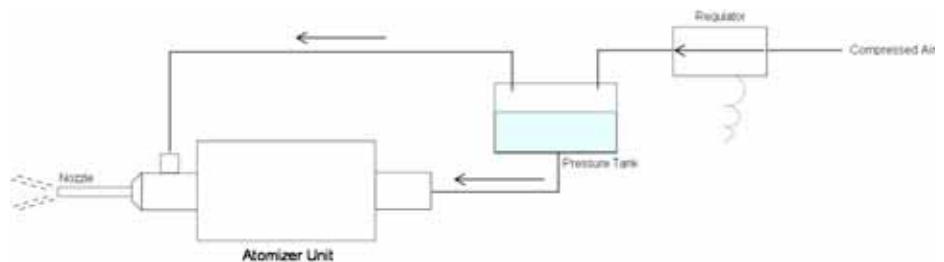
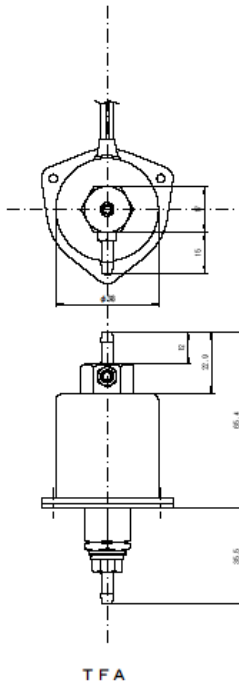
COMPOSITION

Nippon Control Kogyo Co., Ltd. Sales Dep.

5-1-16 Chiyoda, Sakado, Saitama. 3500214 JAPAN

TEL: 81.49.283.7711 FAX: 81.49.283.7717 E-mail: inquiry@nipcon.co.jp URL: http://www.nipcon.co.jp